



Intake/delivery connections 1" - flow rate 100 l/min

# BOXER 80 - 81



STANDARD: II 3/3G D IIB T 135°C (zone 2)  
CONDUCT: II 2/2GD c IIB T 135°C (zone 1)



BOXER 81 PP

Intake/delivery connections G 1" (standard)  
with flange DN 25 (on request)

Air connection G 3/8" f

Max. self-priming capacity\* 6 m

Max. flow rate\* 100 l/min

Max. head\* 70 m

Max. air supply pressure 7 bar

Max. diameter of passing solids (spherical particles) 4 mm

Construction materials	Weight	Max. operating temp.
PP	5 Kg	60°C
PVDF	6,5 Kg	95°C
ALU	6,5 Kg	95°C
Aisi 316	10,5 Kg	95°C

## TECHNICAL DATA



BOXER 81 PVDF



BOXER 81 ALU

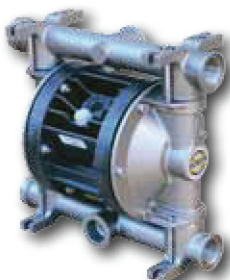

BOXER 80 Aisi 316

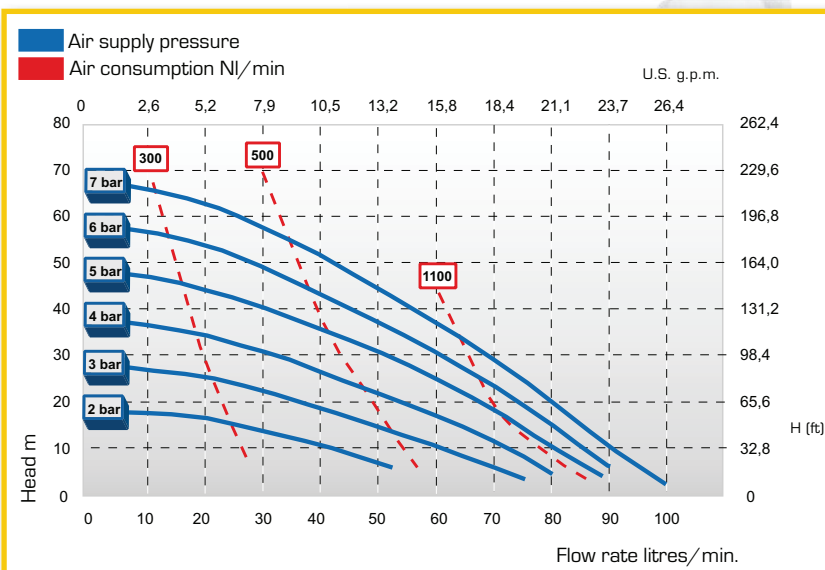

PERFORMANCE

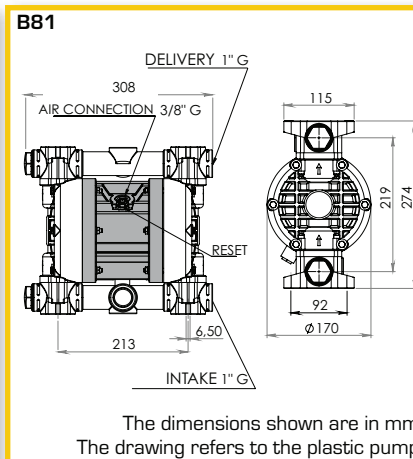
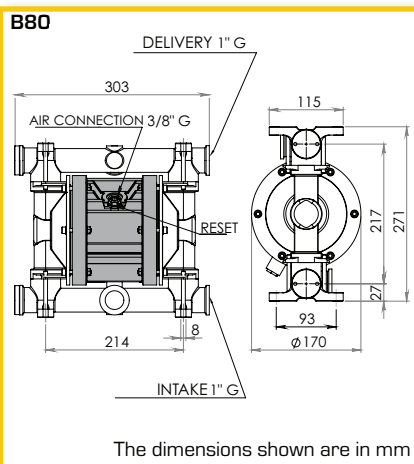

DIMENSIONS

\*The curves and performance values refer to pumps with submerged suction and a free delivery outlet with water at 20°C, and vary according to the construction material. All the values shown are approximate and not binding