



Intake/delivery connections 1/2" - flow rate 30 l/min

# MICROBOXER



STANDARD: II 3/3G D IIB T 135°C (zone 2)  
 CONDUCT: II 2/2GD c IIB T 135°C (zone 1)

Intake/delivery connections	G 1/2" f
Air connection	G 1/4" f
Max. self-priming capacity*	6 m
Max. flow rate*	30 l/min
Max. head*	70 m
Max. air supply pressure	7 bar
Max. diameter of passing solids (spherical particles)	2 mm

Construction materials	Weight	Max. operating temp.
PP	1,6 Kg	60°C
PVDF	1,9 Kg	95°C
Alu	2 Kg	95°C
Aisi 316	3,8 Kg	95°C



PP

## TECHNICAL DATA



PVDF



ALU



AISI 316

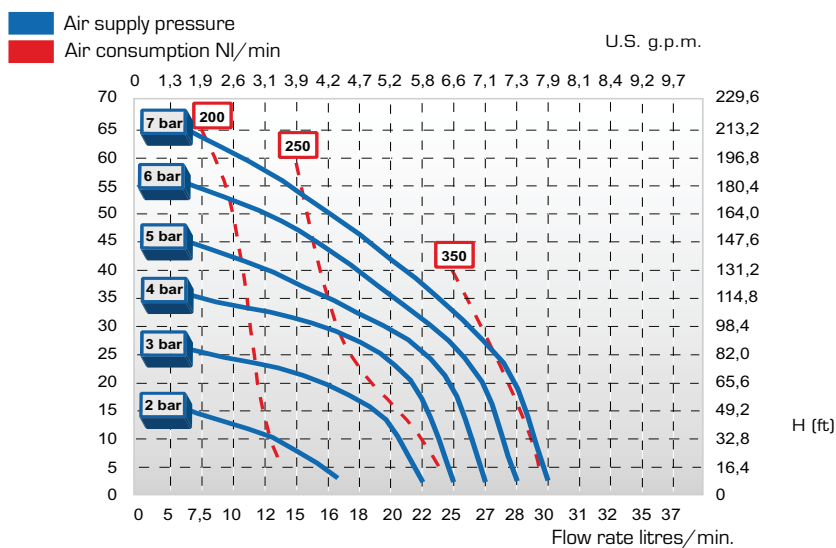

PERFORMANCE

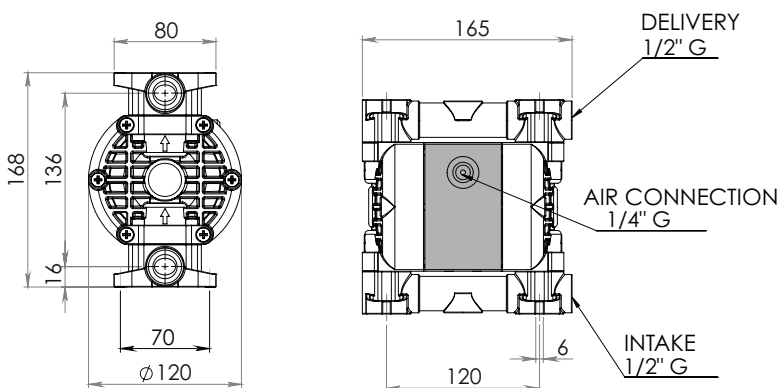

The drawing refers to the plastic pump. The dimensions shown are in mm

\*The curves and performance values refer to pumps with submerged suction and a free delivery outlet with water at 20°C, and vary according to the construction material. All the values shown are approximate and not binding

DIMENSIONS